

Copyright:Copyright infingmengt reserved

INOVANCE

A3

Amendment	Description

Unit: Millimeter (mm)

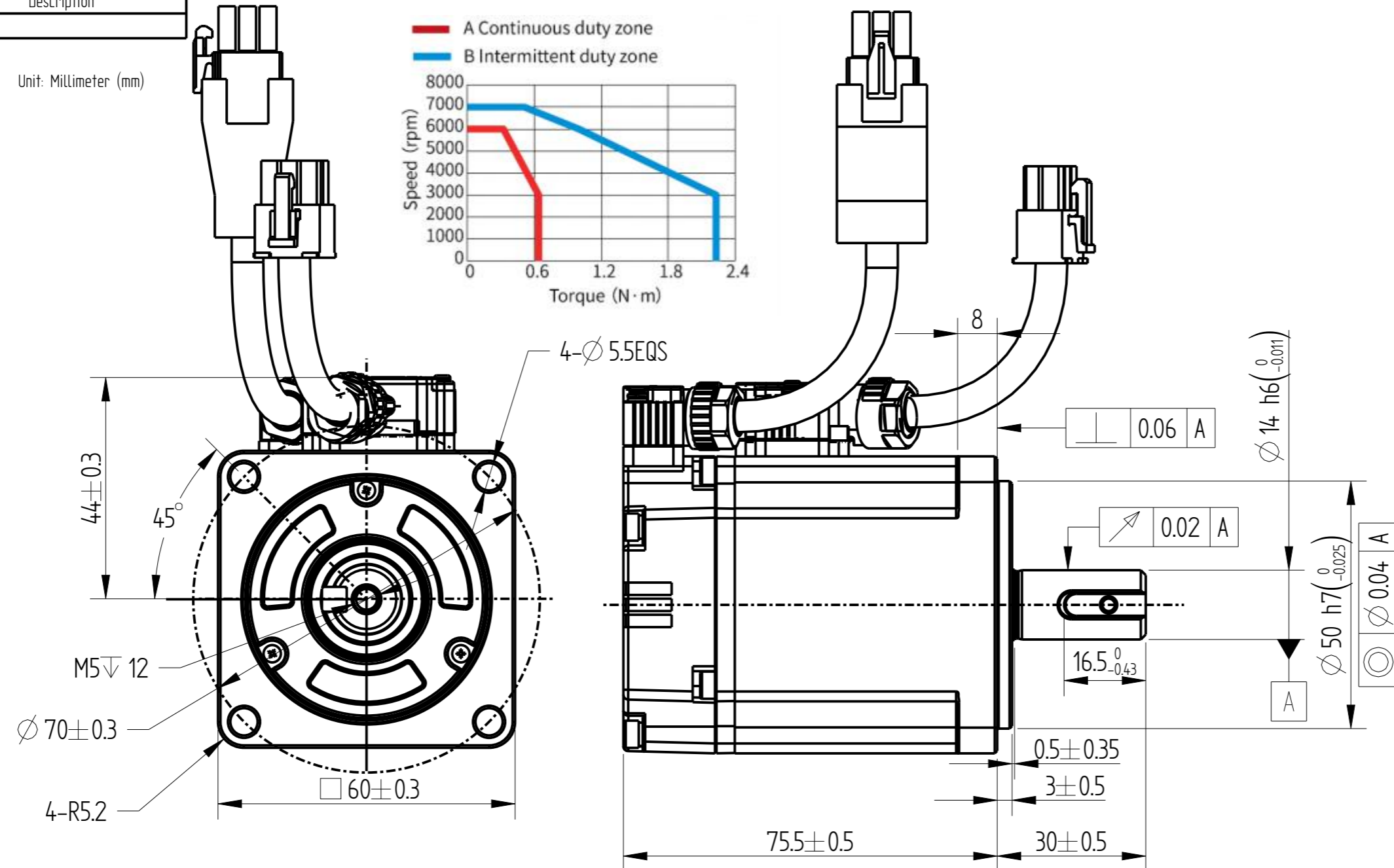

Basic function parameters	
Rated power kW	0.2
Rated voltage V	220
Rated current A	1.5
Peak current at rated speed A	5.3
Rated torque Nm	0.64
Peak torque at rated speed Nm	2.24
Rated speed rpm	3000
Max speed rpm	7000
Rotor inertia $\text{kg} \cdot \text{cm}^2$	$0.094 \pm 10\%$
Encoder resolution	26bit
Insulation class	F (155)
Protection class	IP67
Static torque of brake Nm	/
Brake power supply V	/
Brake backlash°	/
Duty cycle	S1
Radial load N	≤ 245
Axial load N	≤ 74

Encoder adapter connector

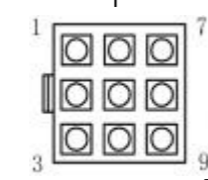

9pin terminal	3	6	1	4	9	8	7
Core color	blue	purple	brown	black	red	orange	groud wire
definition	PS+	PS-	DC+	DC-	+5V	0V	shield
	Pair		Pair		Pair		

Power wire adapter connector

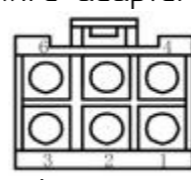

6pin terminal	5	4	2	1	3	6
Core color	chartreuse	red	yellow	white	brown	blue
definition	PE	W	V	U	BK+	BK-

note:
1、The lead wire cable length is 300 ± 20 mm

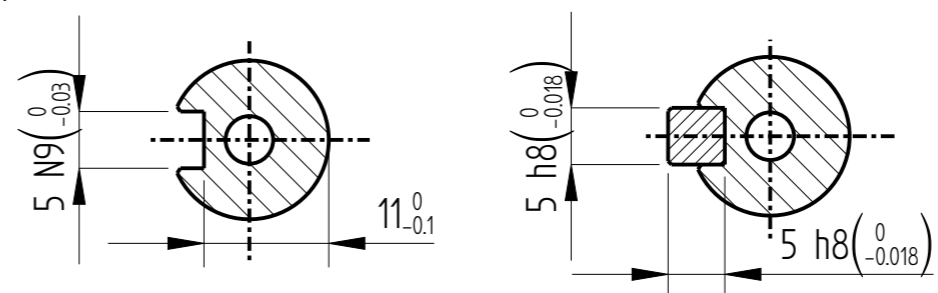

Dimension of shaft end

Dimension of shaft end with key

Motor Outline Drawing				0111A161-WX	
B01	Replace	/	20250526	<div>Mark</div> <div></div> <div>INOVANCE</div>	
Version	Change method	Changed by	Date		
Design	/	/	/		
Check	/	/	/		
Craft	/	/	/	Page 1 of 1	
Verify	/	/	/		
Standardization	/	/	/		
Approve	/	/	/	Weight	Scale
				0.8kg	1:1
				Version	B01
				Model	MS1H1-20B30CB-A331R-S-INT